

FEMALE CONNECTOR

TUBE O.D.	FEMALE THREAD	PART NO.	L	L2	L1	F
INCHES						
1/8	1/8	FC2-2	1.14	0.60	0.880	9/16
1/8	1/4	FC2-4	1.32	0.60	1.060	3/4
1/4	1/8	FC4-2	1.23	0.70	0.940	9/16
1/4	1/4	FC4-4	1.42	0.70	1.130	3/4
1/4	3/8	FC4-6	1.48	0.70	1.190	7/8
1/4	1/2	FC4-8	1.67	0.70	1.380	1-1/16
5/16	1/8	FC5-2	1.27	0.73	0.970	9/16
5/16	1/4	FC5-4	1.46	0.73	1.160	3/4
5/16	3/8	FC5-6	1.52	0.73	1.219	7/8
3/8	1/8	FC6-2	1.29	0.76	1.000	5/8
3/8	1/4	FC6-4	1.48	0.76	1.190	3/4
3/8	3/8	FC6-6	1.54	0.76	1.250	7/8
3/8	1/2	FC6-8	1.73	0.76	1.440	1-1/16
3/8	3/4	FC6-12	1.85	0.76	1.560	1-1/4
1/2	1/4	FC8-4	1.59	0.87	1.190	13/16
1/2	3/8	FC8-6	1.65	0.87	1.250	7/8
1/2	1/2	FC8-8	1.84	0.87	1.440	1-1/16
1/2	3/4	FC8-12	1.96	0.87	1.560	1-1/4
5/8	3/8	FC10-6	1.65	0.87	1.250	15/16
5/8	1/2	FC10-8	1.84	0.87	1.440	1-1/16
5/8	3/4	FC10-12	1.96	0.87	1.560	1-3/8
3/4	1/2	FC12-8	1.84	0.87	1.440	1-1/16
3/4	3/4	FC12-12	1.96	0.87	1.560	1-3/8
1	3/4	FC16-12	2.15	1.05	1.660	1-3/8
1	1	FC16-16	2.46	1.05	1.970	1-5/8

Dimensions for reference only, subject to change without prior notice

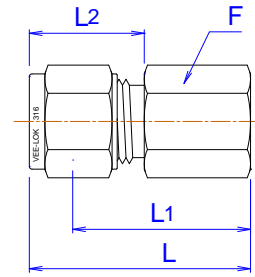

FEMALE CONNECTOR

TUBE O.D.	FEMALE THREAD	PART NO.	L	L2	L1	F
MILLIMETERS						
6	1/8	MFC6-2	31.30	17.70	23.80	14
6	1/4	MFC6-4	36.10	17.70	28.60	19
6	3/8	MFC6-6	37.70	17.70	30.20	22
6	1/2	MFC6-8	42.50	17.70	35.00	27
8	1/8	MFC8-2	32.10	18.60	24.60	14
8	1/4	MFC8-4	36.90	18.60	29.40	19
8	3/8	MFC8-6	38.50	18.60	31.00	22
10	1/4	MFC10-4	37.80	19.50	30.20	19
10	3/8	MFC10-6	39.40	19.50	31.80	22
10	1/2	MFC10-8	44.10	19.50	36.50	27
12	1/4	MFC12-4	41.90	22.00	31.80	22
12	3/8	MFC12-6	41.90	22.00	31.80	22
12	1/2	MFC12-8	46.60	22.00	36.50	27
16	3/8	MFC16-6	41.90	22.00	31.80	24
16	1/2	MFC16-8	46.90	22.00	36.50	27
20	1/2	MFC20-8	47.90	22.00	37.80	30
20	3/4	MFC20-12	49.70	22.00	39.60	35
22	3/4	MFC22-12	49.70	22.00	39.60	35
25	3/4	MFC25-12	53.60	26.50	41.30	35
25	1	MFC25-16	62.30	26.50	50.00	41

Dimensions for reference only, subject to change without prior notice