

MALE CONNECTOR

TUBE O.D.	MALE THREAD	PART NO.	L	L1	L2	H	F
INCHES							
1/8	1/8	MC2-2	1.20	0.60	0.94	0.38	7/16
1/8	1/4	MC2-4	1.40	0.60	1.14	0.56	9/16
1/8	3/8	MC2-6	1.42	0.60	1.16	0.56	11/16
1/8	1/2	MC2-8	1.67	0.60	1.41	0.75	7/8
1/4	1/8	MC4-2	1.29	0.70	1.00	0.38	1/2
1/4	1/4	MC4-4	1.49	0.70	1.20	0.56	9/16
1/4	3/8	MC4-6	1.51	0.70	1.22	0.56	11/16
1/4	1/2	MC4-8	1.76	0.70	1.47	0.75	7/8
1/4	3/4	MC4-12	1.82	0.70	1.53	0.75	1-1/16
5/16	1/8	MC5-2	1.34	0.73	1.05	0.38	9/16
5/16	1/4	MC5-4	1.52	0.73	1.23	0.56	9/16
5/16	3/8	MC5-6	1.55	0.73	1.25	0.56	11/16
5/16	1/2	MC5-8	1.79	0.73	1.50	0.75	7/8
3/8	1/8	MC6-2	1.38	0.76	1.09	0.38	5/8
3/8	1/4	MC6-4	1.57	0.76	1.28	0.56	5/8
3/8	3/8	MC6-6	1.57	0.76	1.28	0.56	11/16
3/8	1/2	MC6-8	1.82	0.76	1.53	0.75	7/8
3/8	3/4	MC6-12	1.88	0.76	1.59	0.75	1-1/16
1/2	1/8	MC8-2	1.53	0.87	1.13	0.38	13/16
1/2	1/4	MC8-4	1.71	0.87	1.31	0.56	13/16
1/2	3/8	MC8-6	1.71	0.87	1.31	0.56	13/16
1/2	1/2	MC8-8	1.93	0.87	1.53	0.75	7/8
1/2	3/4	MC8-12	1.99	0.87	1.59	0.75	1-1/16
1/2	1	MC8-16	2.28	0.87	1.88	0.94	1-3/8
5/8	3/8	MC10-6	1.74	0.87	1.34	0.56	15/16
5/8	1/2	MC10-8	1.93	0.87	1.53	0.75	15/16
5/8	3/4	MC10-12	1.99	0.87	1.59	0.75	1-1/16
3/4	1/2	MC12-8	1.99	0.87	1.59	0.75	1-1/16
3/4	3/4	MC12-12	1.99	0.87	1.59	0.75	1-1/16
3/4	1	MC12-16	2.28	0.87	1.88	0.94	1-3/8
1	1/2	MC16-8	2.27	1.05	1.78	0.75	1-3/8
1	3/4	MC16-12	2.27	1.05	1.78	0.75	1-3/8
1	1	MC16-16	2.46	1.05	1.97	0.94	1-3/8

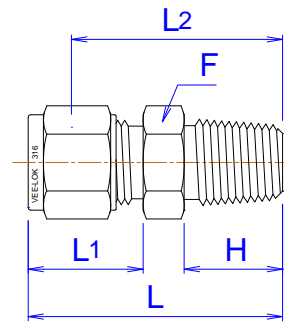

MALE CONNECTOR

TUBE O.D.	MALE THREAD	PART NO.	L	L1	L2	H	F
MILLIMETERS							
6	1/8	MMC6-2	32.90	17.70	25.40	9.50	14
6	1/4	MMC6-4	38.10	17.70	30.60	14.30	14
6	3/8	MMC6-6	38.50	17.70	31.00	14.30	18
6	1/2	MMC6-8	44.80	17.70	37.30	19.10	22
8	1/8	MMC8-2	34.20	18.60	26.70	9.50	15
8	1/4	MMC8-4	38.80	18.60	31.30	14.30	15
8	3/8	MMC8-6	39.30	18.60	31.80	14.30	18
8	1/2	MMC8-8	45.60	18.60	38.10	19.10	22
10	1/8	MMC10-2	36.10	19.50	28.60	9.50	18
10	1/4	MMC10-4	40.90	19.50	33.30	14.30	18
10	3/8	MMC10-6	40.90	19.50	33.30	14.30	18
10	1/2	MMC10-8	47.50	19.50	38.90	19.10	22
10	3/4	MMC10-12	46.40	19.50	38.90	19.10	27
10	1	MMC10-16	55.00	19.50	47.50	23.80	35
12	1/4	MMC12-4	43.40	22.00	33.30	14.30	22
12	3/8	MMC12-6	43.40	22.00	33.30	14.30	22
12	1/2	MMC12-8	49.00	22.00	38.90	19.10	22
12	3/4	MMC12-12	50.50	22.00	40.40	19.10	27
14	1/4	MMC14-4	44.20	22.00	34.10	14.30	24
14	3/8	MMC14-6	44.20	22.00	34.10	14.30	24
14	1/2	MMC14-8	49.00	22.00	38.90	19.10	24
15	1/2	MMC15-8	49.00	22.00	38.90	19.10	24
16	3/8	MMC16-6	44.10	22.00	34.01	14.30	24
16	1/2	MMC16-8	49.00	22.00	38.90	19.10	24
16	3/4	MMC16-12	50.50	22.00	40.50	19.10	27
18	1/2	MMC18-8	50.60	22.00	40.50	19.10	27
18	3/4	MMC18-12	50.60	22.00	40.50	19.10	27
20	1/2	MMC20-8	50.60	22.00	42.20	19.10	30
20	3/4	MMC20-12	52.30	22.00	42.20	19.10	30
20	1	MMC20-16	57.70	22.00	47.60	23.80	35
22	3/4	MMC22-12	52.30	22.00	42.20	19.10	30
25	1/2	MMC25-8	57.50	26.50	45.30	19.10	35
25	3/4	MMC25-12	57.50	26.50	45.20	19.10	35
25	1	MMC25-16	62.30	26.50	50.00	23.80	35

Dimensions for reference only, subject to change without prior notice