

VEE-LOK Pipe Fittings

HEX NIPPLE

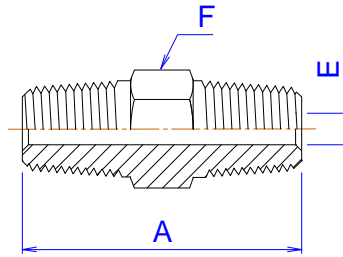

Male NPT Threads

PIPE THREAD	PART NO.	A	E	F
INCHES				
1/8	HN2	1.01	0.19	7/16
1/4	HN4	1.40	0.28	9/16
3/8	HN6	1.43	0.38	11/16
1/2	HN8	1.84	0.47	7/8
3/4	HN12	1.84	0.62	1-1/16
1	HN16	2.32	0.88	1-3/8

HEX LONG NIPPLE

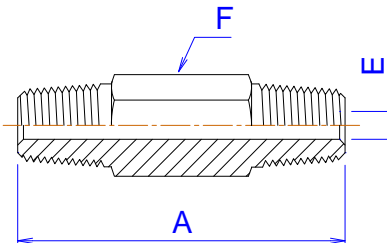

Male NPT Threads

PIPE THREAD	PART NO.	A					E	F
		Available Lengths, inch						
		1.50	2.00	2.50	3.00	4.00		
INCHES								
1/8	HLN2	V	V	V	V	—	0.19	7/16
1/4	HLN4	V	V	V	V	V	0.28	9/16
3/8	HLN6	V	V	V	V	V	0.38	11/16
1/2	HLN8	—	V	—	V	V	0.47	7/8
3/4	HLN12	—	V	—	V	V	0.62	1-1/16
1	HLN16	—	—	—	V	V	0.88	1-3/8



VEE-LOK Pipe Fittings

HEX REDUCING NIPPLE

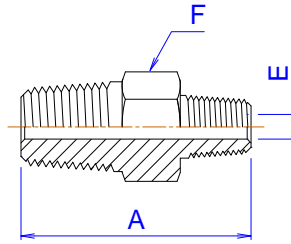

Male NPT Threads

PIPE THREAD	MALE THREAD	PART NO.	A	E	F
INCHES					
1/4	1/8	HRN4-2	1.22	0.19	9/16
3/8	1/8	HRN6-2	1.25	0.19	11/16
3/8	1/4	HRN6-4	1.43	0.28	11/16
1/2	1/8	HRN8-2	1.47	0.19	7/8
1/2	1/4	HRN8-4	1.65	0.28	7/8
1/2	3/8	HRN8-6	1.65	0.38	7/8
3/4	1/4	HRN12-4	1.65	0.28	1-1/16
3/4	1/2	HRN12-8	1.84	0.47	1-1/16
1	1/2	HRN16-8	2.13	0.47	1-3/8
1	3/4	HRN16-12	2.13	0.62	1-3/8

ADAPTER

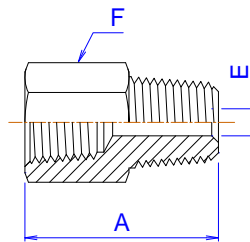

Female to Male NPT Threads

PIPE THREAD	PART NO.	A	E	F
INCHES				
1/8	A2	1.10	0.19	9/16
1/4	A4	1.40	0.28	3/4
3/8	A6	1.51	0.38	7/8
1/2	A8	1.94	0.47	1-1/16
3/4	A12	2.02	0.62	1-5/16
1	A16	2.28	0.88	1-5/8



Dimensions for reference only, subject to change without prior notice

VEE-LOK Pipe Fittings

REDUCING ADAPTER

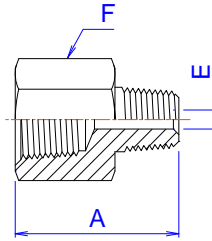

Female to Male NPT Threads

FEMALE THREAD	MALE THREAD	PART NO.	A	E	F
INCHES					
1/4	1/8	RA4-2	1.26	0.19	3/4
3/8	1/8	RA6-2	1.33	0.19	7/8
3/8	1/4	RA6-4	1.50	0.28	7/8
1/2	1/8	RA8-2	1.58	0.19	1-1/16
1/2	1/4	RA8-4	1.76	0.28	1-1/16
1/2	3/8	RA8-6	1.75	0.38	1-1/16
3/4	1/4	RA12-4	1.85	0.28	1-5/16
3/4	3/8	RA12-6	1.82	0.38	1-5/16
3/4	1/2	RA12-8	2.02	0.47	1-5/16
1	1/4	RA16-4	1.96	0.28	1-5/8
1	1/2	RA16-8	2.16	0.47	1-5/8
1	3/4	RA16-12	2.17	0.62	1-5/8

REDUCING BUSHING

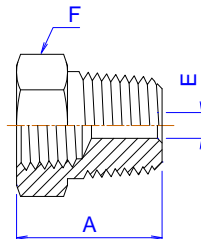

Male to Female NPT Threads

MALE THREAD	FEMALE THREAD	PART NO.	A	E	F
INCHES					
1/4	1/8	RB4-2	1.06	0.28	9/16
3/8	1/8	RB6-2	0.86	0.34	11/16
3/8	1/4	RB6-4	1.19	0.38	3/4
1/2	1/8	RB8-2	1.08	0.34	7/8
1/2	1/4	RB8-4	1.08	0.45	7/8
1/2	3/8	RB8-6	1.41	0.47	7/8
3/4	1/4	RB12-4	1.08	0.45	1-1/16
3/4	3/8	RB12-6	1.08	0.59	1-1/16
3/4	1/2	RB12-8	1.63	0.62	1-1/16
1	1/4	RB16-4	1.37	0.45	1-3/8
1	3/8	RB16-6	1.37	0.59	1-3/8
1	1/2	RB16-8	1.37	0.73	1-3/8
1	3/4	RB16-12	1.85	0.88	1-3/8

Dimensions for reference only, subject to change without prior notice



VEE-LOK Pipe Fittings

HEX COUPLING

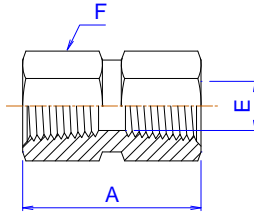

Female NPT Threads

PIPE THREAD	PART NO.	A	E	F
INCHES				
1/8	HC2	0.81	0.34	9/16
1/4	HC4	1.19	0.45	3/4
3/8	HC6	1.31	0.59	7/8
1/2	HC8	1.56	0.73	1-1/16
3/4	HC12	1.62	0.94	1-5/16
1	HC16	2.00	1.17	1-5/8

HEX REDUCING COUPLING

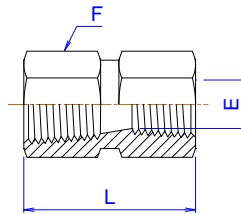

Female NPT Threads

FEMALE THREAD	FEMALE THREAD	PART NO.	A	E	F
INCHES					
1/4	1/8	HRC4-2	1.22	0.34	3/4
3/8	1/4	HRC6-4	1.38	0.45	7/8
1/2	1/8	HRC8-2	1.56	0.34	1-1/16
1/2	1/4	HRC8-4	1.75	0.45	1-1/16
1/2	3/8	HRC8-6	1.78	0.59	1-1/16
3/4	1/4	HRC12-4	1.81	0.45	1-5/16
3/4	1/2	HRC12-8	2.06	0.73	1-5/16
1	1/2	HRC16-8	2.19	0.73	1-5/8
1	3/4	HRC16-12	2.25	0.94	1-5/8

PIPE PLUG

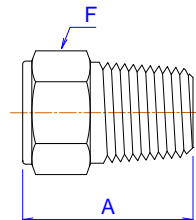

Male NPT Threads

MALE THREAD	PART NO.	A	F
INCHES			
1/8	PP2	0.75	7/16
1/4	PP4	0.96	9/16
3/8	PP6	0.99	11/16
1/2	PP8	1.21	7/8
3/4	PP12	1.21	1-1/16
1	PP16	1.50	1-3/8

Dimensions for reference only, subject to change without prior notice

