

ADAPTER

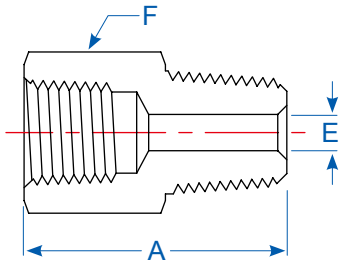

Female to Male NPT Threads

PIPE THREAD	PART NO.	Dimensions (inch)		
		A	E	F
1/8	A2	1.10	0.19	9/16
1/4	A4	1.40	0.28	3/4
3/8	A6	1.51	0.38	7/8
1/2	A8	1.85	0.47	1-1/16
3/4	A12	1.85	0.62	1-3/8
1	A16	2.20	0.88	1-5/8

REDUCING ADAPTER

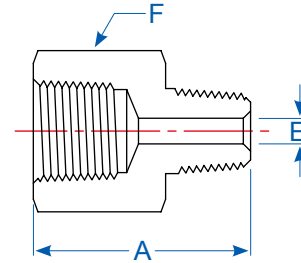

Female to Male NPT Threads

FEMALE THREAD	MALE THREAD	PART NO.	Dimensions (inch)		
			A	E	F
1/4	1/8	RA4-2	1.26	0.19	3/4
3/8	1/8	RA6-2	1.33	0.19	7/8
3/8	1/4	RA6-4	1.50	0.28	7/8
1/2	1/8	RA8-2	1.49	0.19	1-1/16
1/2	1/4	RA8-4	1.66	0.28	1-1/16
1/2	3/8	RA8-6	1.66	0.38	1-1/16
3/4	1/4	RA12-4	1.66	0.28	1-3/8
3/4	3/8	RA12-6	1.66	0.38	1-3/8
3/4	1/2	RA12-8	1.85	0.47	1-3/8
1	1/4	RA16-4	1.96	0.28	1-5/8
1	1/2	RA16-8	2.16	0.47	1-5/8
1	3/4	RA16-12	2.17	0.62	1-5/8

REDUCING BUSHING

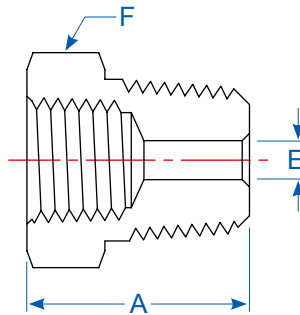

Male to Female NPT Threads

MALE THREAD	FEMALE THREAD	PART NO.	Dimensions (inch)		
			A	E	F
1/4	1/8	RB4-2	1.06	0.28	9/16
3/8	1/8	RB6-2	0.86	0.34	11/16
3/8	1/4	RB6-4	1.19	0.38	3/4
1/2	1/8	RB8-2	1.08	0.34	7/8
1/2	1/4	RB8-4	1.08	0.45	7/8
1/2	3/8	RB8-6	1.41	0.47	7/8
3/4	1/4	RB12-4	1.08	0.45	1-1/16

MALE THREAD	FEMALE THREAD	PART NO.	Dimensions (inch)		
			A	E	F
3/4	3/8	RB12-6	1.08	0.59	1-1/16
3/4	1/2	RB12-8	1.63	0.62	1-1/16
1	1/4	RB16-4	1.37	0.45	1-3/8
1	3/8	RB16-6	1.37	0.59	1-3/8
1	1/2	RB16-8	1.37	0.73	1-3/8
1	3/4	RB16-12	1.85	0.88	1-3/8

Dimensions for reference only, subject to change